

SHEET NUMBER	N 1111/2	REVISION 0
DRAWING TITLE	TOPOGRAPHICAL	
SCALE	1 : 200 (A0)	
SEE ALSO DWG NOS		
SHEET	2 of 14	
JOB NUMBER	N 1111	

ADDITIONAL NOTES

COORDINATES USED ARE BASED ON ORDNANCE SURVEY NATIONAL GRID OBTAINED USING THE ACTIVE GPS NETWORK AND ADJUSTED TO A LOCAL GRID WITH A SCALE FACTOR OF 1.0000.

LEVELS ARE RELATED TO :- ORDNANCE SURVEY ACTIVE GPS NETWORK.

SURVEY CONTROL STATIONS SHOWN

ABBREVIATIONS (where applicable)

A	Assault/assaults	OH	Overhead
B	Belt	PM	Plumbing
C	Air-Con Unit	PM	Post Box
D	Door	PM	Postage
E	Armed	PL	PL Graph
F	Force	PE	PE Key
G	Gas	PL	PL Level
H	Beliefs Belcon	PM	Plumbing Water
I	Inter	PM	Post Box
J	Bed	PS	Postage
K	Keel	PT	Post Time
L	Lock	PT	Post Time
M	Men	P/W	Post and Waste
N	Need	KE	Keating Key
O	Opening	KE	Keating
P	Police	RS	Revised Sheet
Q	Quota	SI	SI
R	Room	SA	Survey Amendment
S	Shower	SB	Shower
T	Talk	CI	Intending Connection
U	Unit	CI	Intending Connection
V	Value	CI	Intending Connection
W	Water	CI	Intending Connection
X	Box	CI	Intending Connection
Y	Year	CI	Intending Connection
Z	Zone	CI	Intending Connection
AA	Area	CI	Intending Connection
AB	Area	CI	Intending Connection
AC	Area	CI	Intending Connection
AD	Area	CI	Intending Connection
AE	Area	CI	Intending Connection
AF	Area	CI	Intending Connection
AG	Area	CI	Intending Connection
AH	Area	CI	Intending Connection
AI	Area	CI	Intending Connection
AJ	Area	CI	Intending Connection
AK	Area	CI	Intending Connection
AL	Area	CI	Intending Connection
AM	Area	CI	Intending Connection
AN	Area	CI	Intending Connection
AO	Area	CI	Intending Connection
AP	Area	CI	Intending Connection
AQ	Area	CI	Intending Connection
AR	Area	CI	Intending Connection
AS	Area	CI	Intending Connection
AT	Area	CI	Intending Connection
AU	Area	CI	Intending Connection
AV	Area	CI	Intending Connection
AW	Area	CI	Intending Connection
AX	Area	CI	Intending Connection
AY	Area	CI	Intending Connection
AZ	Area	CI	Intending Connection
BA	Area	CI	Intending Connection
BB	Area	CI	Intending Connection
BC	Area	CI	Intending Connection
BD	Area	CI	Intending Connection
BE	Area	CI	Intending Connection
BF	Area	CI	Intending Connection
BG	Area	CI	Intending Connection
BH	Area	CI	Intending Connection
BI	Area	CI	Intending Connection
BJ	Area	CI	Intending Connection
BK	Area	CI	Intending Connection
BL	Area	CI	Intending Connection
BM	Area	CI	Intending Connection
BN	Area	CI	Intending Connection
BO	Area	CI	Intending Connection
BP	Area	CI	Intending Connection
BQ	Area	CI	Intending Connection
BR	Area	CI	Intending Connection
BS	Area	CI	Intending Connection
BT	Area	CI	Intending Connection
BU	Area	CI	Intending Connection
BV	Area	CI	Intending Connection
BW	Area	CI	Intending Connection
BX	Area	CI	Intending Connection
BY	Area	CI	Intending Connection
BZ	Area	CI	Intending Connection
CA	Area	CI	Intending Connection
CB	Area	CI	Intending Connection
CC	Area	CI	Intending Connection
CD	Area	CI	Intending Connection
CE	Area	CI	Intending Connection
CF	Area	CI	Intending Connection
CG	Area	CI	Intending Connection
CH	Area	CI	Intending Connection
CI	Area	CI	Intending Connection
CJ	Area	CI	Intending Connection
CK	Area	CI	Intending Connection
CL	Area	CI	Intending Connection
CM	Area	CI	Intending Connection
CN	Area	CI	Intending Connection
CO	Area	CI	Intending Connection
CP	Area	CI	Intending Connection
CQ	Area	CI	Intending Connection
CR	Area	CI	Intending Connection
CS	Area	CI	Intending Connection
CT	Area	CI	Intending Connection
CU	Area	CI	Intending Connection
CV	Area	CI	Intending Connection
CW	Area	CI	Intending Connection
CX	Area	CI	Intending Connection
CY	Area	CI	Intending Connection

NOTES

- * Drainage pipe sizes (where shown) have been gauged from the surface for safety reasons and should be regarded as approximate only.
- * Tree species (where shown) should be treated with caution and expert identification is advised.
- * Although this is a digital survey the accuracy and amount of detail shown is only commensurate with the graphical scale of mapping as specified. Care should be exercised when working to larger scales.
- * Visible features in the vicinity of the boundaries as shown above, may represent the extent of legally conveyed ownership.
- * Whilst every effort has been made to achieve accuracy on this plan, C, clearance dimensions, levels and invert levels should be checked prior to design and construction.
- * Kern levels have been taken in the bottom of the channel.
- * Store fronts have been represented by a generalised line between piers.

SHEET LAYOUT
OVER THE TABLE

(NOT TO SCALE)

HIGHWAY SURVEY (TOPOGRAPHICAL) EXAMPLE

TOPOGRAPHICAL SURVEY

SURVEYED FOR:	CLIENT NAME	SURVEYOR:	OPERATIVE NAME
	ADDRESS 1		
	ADDRESS 2	DATE:	DATE OF ISSUE
	ADDRESS 3		
	POSTCODE		

NO	DATE	REVISION NOTES

SHEET NUMBER	N 1111/9	REVISION C
--------------	----------	------------

DRAWING TITLE	TOPOGRAPHICAL
---------------	---------------

SCALE	1 : 200 (A0)

SEE ALSO DWG NOS	

SHEET	9 of 14
JOB NUMBER	N 1111

USD NUMBER	N 1111

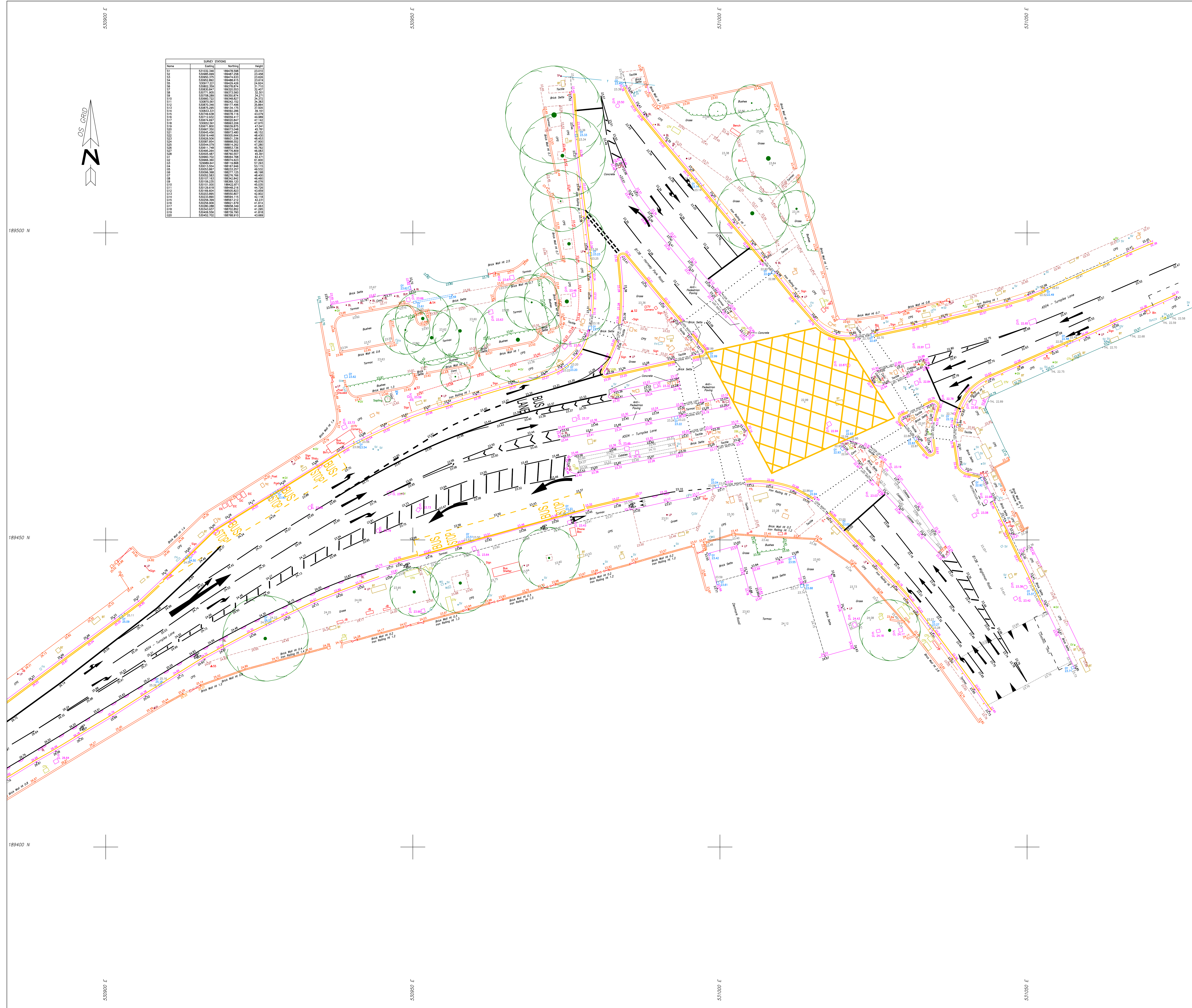

DATUM NOTES

CO-ORDINATES USED ARE BASED ON ORDNANCE SURVEY NATIONAL GRID OBTAINED USING THE ACTIVE GPS NETWORK AND ADJUSTED TO A LOCAL GRID WITH A SCALE FACTOR OF 1.0000.

LEVELS ARE RELATED TO :- ORDNANCE SURVEY ACTIVE GPS NETWORK.

SURVEY CONTROL STATIONS SHOWN

ABBREVIATIONS (where applicable)

[illegible]

NOTES

- * Drainage pipe sizes (where shown) have been gauged from the surface for safety reasons and should be regarded as approximate only.
- * Tree species (where shown) should be treated with caution and expert identification is advised.
- * Although this is a digital survey the accuracy and amount of detail shown is only commensurate with the graphical scale of mapping as specified. Care should be exercised when working to larger scales.
- * Visible features in the vicinity of the boundaries as shown above, may not represent the extent of legal ownership.
- * Whilst every effort has been made to achieve accuracy on this plan, CRUCI clearance dimensions, levels and invert levels should be checked prior to any ground construction.
- * Kerb levels have been taken in the bottom of the channel.
- * Stone forêts have been represented by a generalised line between points.

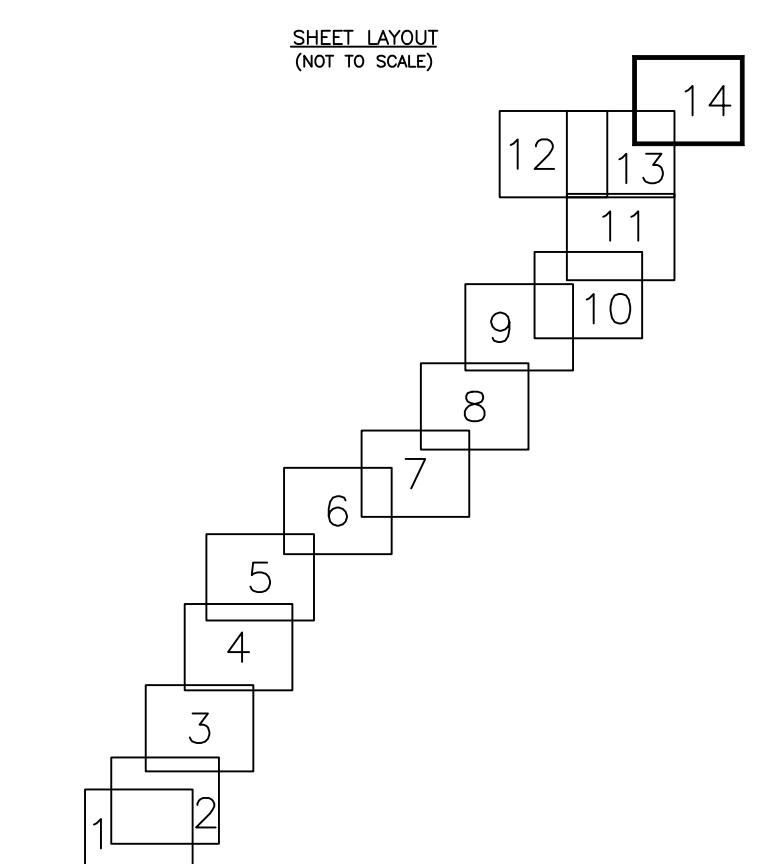

HIGHWAY SURVEY (TOPOGRAPHICAL) EXAMPLE

TOPOGRAPHICAL SURVEY

SURVEYED FOR:	CLIENT NAME	SURVEYOR:	OPERATIVE NAME
	ADDRESS 1		DATE:
	ADDRESS 2		DATE OF ISSUE
	ADDRESS 3		
	POSTCODE		

NO	DATE	REVISION NOTES

SHEET NUMBER	N 1111/14	REVIS
DRAWING TITLE	TERRACOTTA	

DRAWING TITLE	TOPOGRAPHICAL
SCALE	1 : 200 (A0)

SEE ALSO DWG NOS	
SHEET	14 of 14

JOB NUMBER	N 1111
------------	--------